

Emergency lighting units

## High quality for professional applications

LiFePO<sub>4</sub> Accus 1.5 – 9.0 Ah



**TRIDONIC**

## Emergency lighting units

# LiFePO<sub>4</sub> Accus 1.5 – 9.0 Ah

- High-temperature (up to 55°C) Lithium Iron Phosphate cells (LiFePO<sub>4</sub>)
- Design life up to 8-years
- 3 years warranty

### At a glance:

- Environmental friendly technology
- High energy density
- Battery voltage 3.2V
- Capacity per cell 1.5Ah
- Good charging properties at high temperature
- Electronic thermal battery management
- Up to 12 month shelf life
- Certified quality manufacturer
- Suitable for emergency lighting equipment as per IEC 60598-2-22

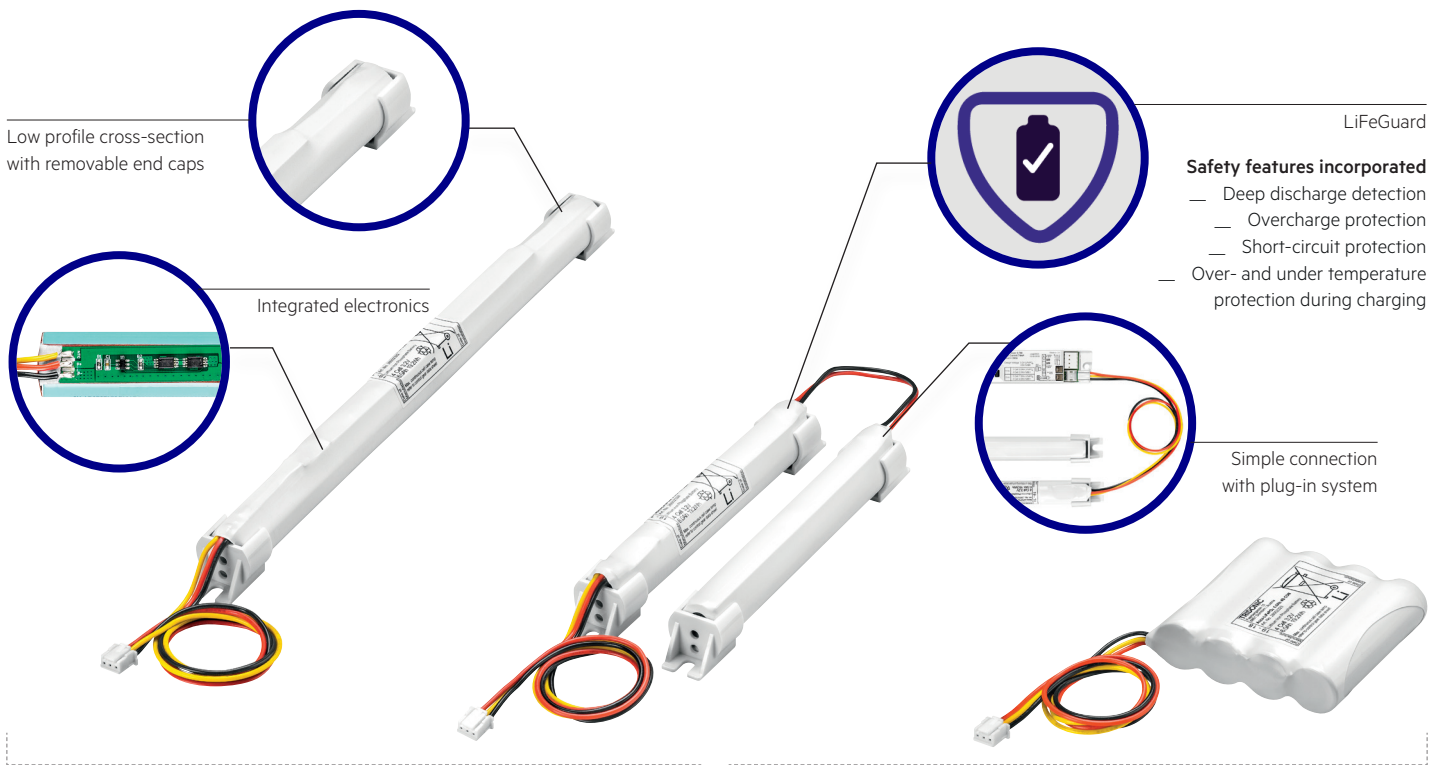

In various configurations

### Did you know

**Safe and reliable operation with LiFeGuard. Three layers of safety features addressing the cell, battery pack and emergency driver combined in the LiFeGuard safety feature.**

- Protection against abnormal operating conditions
- Battery pack with integrated sensor enables constant temperature monitoring
- intelligent charge level dependant charging

