

**sceneCOM evo Touchpanel**

Interactive user interface



**Product description**

- \_ 7" touchpanel for intuitive operation and configuration of a sceneCOM evo system
- \_ Complete access to the web-based sceneCOM evo user interface
- \_ Pre-installed web browser for connection to a sceneCOM evo controller
- \_ Colour display with 1024 x 600 pixel image resolution
- \_ Linux operating system
- \_ Suitable for installation in walls (wallmount box available as an accessory)
- \_ Integrated LAN connection
- \_ Powered via PoE+ or external power supply (available separately as an accessory)
- \_ 2 years guarantee (conditions at <https://www.tridonic.com/en/int/services/manufacturer-guarantee-conditions>)

**Website**

<http://www.tridonic.com/28005694>



**sceneCOM evo Touchpanel**

Interactive user interface

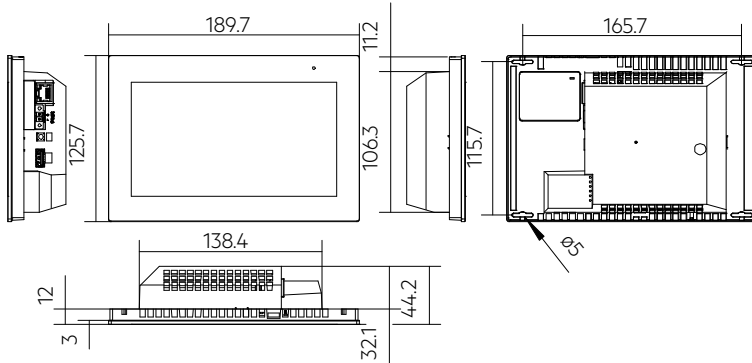

**Ordering data**

Type	Article number	Dimensions L x W x H	Packaging	Weight per pc.
sceneCOM evo Touchpanel	28005694	190 x 126 x 45 mm	1 pc(s).	1.4 kg

**Technical data**

Supply via	External power supply (optional) or PoE+
Rated voltage range DC	22 – 26 V
Current draw	1,000 mA
Power consumption	< 16.3 W
Operating temperature	0 ... +35 °C
Storage temperature ts	-20 ... +70 °C
Humidity	10 ... 80 % not condensed
Touchscreen size	7"
Touchscreen pixel	1,024 x 600
Type of protection	IP20
Housing colour	Black
Dimensions L x W x H	190 x 126 x 45 mm
Guarantee (conditions at <a href="http://www.tridonic.com">www.tridonic.com</a> )	2 Year(s)

**Approval marks**



Wall mounting box

Accessory



Product description

- \_ Wall mounting box for the sceneCOM evo Touchpanel
- \_ Suitable for flush-fitting, cavity and concrete installation
- \_ IP30

Website

<http://www.tridonic.com/28005695>

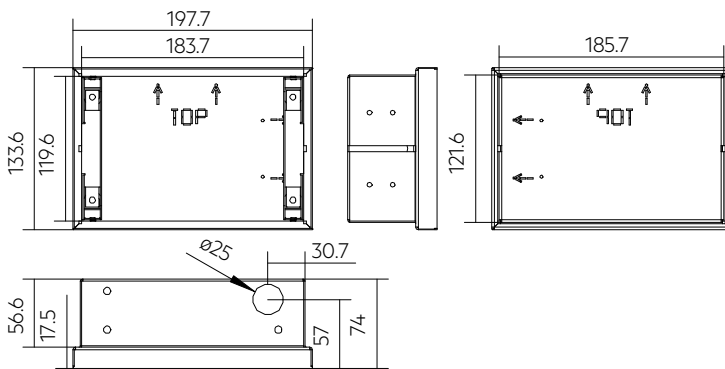

Ordering data

Type	Article number	Dimensions L x W x H	Packaging	Weight per pc.
sceneCOM evo WMB-Touchpanel	28005695	197.7 x 133.6 x 74 mm	1 pc(s).	0.788 kg

Power supply MW 24VDC

Accessory

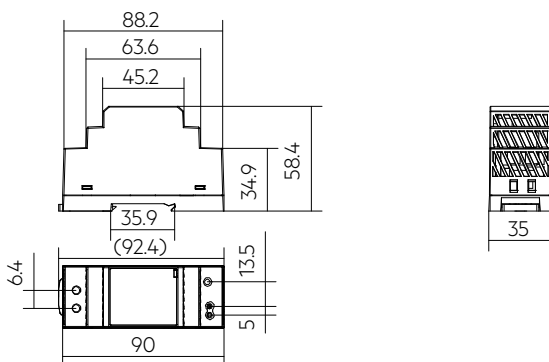

**Product description**

- \_ Ultra slim design with 35 mm (2SU) width
- \_ Power input on stand-by < 0.3 W
- \_ Isolation class II
- \_ Pass LPS (Limited Power Source)
- \_ DC output voltage adjustable
- \_ Protective features (short circuit, overload, over voltage)
- \_ Cooling by free air convection (working temperature: -30 ... +70 °C)
- \_ DIN rail TS-35/7.5 or 15 mountable
- \_ LED indicator for power on
- \_ 3 years guarantee (conditions at <https://www.tridonic.com/en/int/services/manufacturer-guarantee-conditions>)

**Typical applications**

- \_ lichtMONITOR server x5 (28004946)
- \_ sceneCOM evo Touchpanel (28005694)

**Website**

<http://www.tridonic.com/28005796>



**Ordering data**

Type	Article number	Packaging, carton	Weight per pc.
Power supply MW 24VDC	28005796	96 pc(s).	0.13 kg

**Approval marks**



## 1. Common

### 1.1 Description

The sceneCOM evo Touchpanel is a 7 inches multitouch screen to fully master a sceneCOM evo installation by using the sceneCOM evo web application and suitable for wall mounting.

## 2. Installation

- Attach to Ethernet cable using the supplied split ferrite before installation.
- The touchpanel must be installed as described in the manual.
- The default IP address of the sceneCOM evo is: 10.10.40.254.
- The default IP address of the touch panel is: 10.10.40.11.
- The supply voltage on the touchpanel must be between 22 and 26 V DC. Connect the touchpanel only when the supply lines are disconnected from the power. Otherwise the touch panel may start in an impermissible operating status. If this occurs, you will hear a beep or noise on the touchpanel.

## 3. Commissioning

### 3.1 Commissioning version 1: touchpanel directly connected to sceneCOM evo via an ethernet cable

1. Connect the voltage supply to the touchpanel.  
Chromium browser starts in kiosk mode and automatically establishes a connection to the sceneCOM evo.  
The start page of the sceneCOM web application is displayed.

Requirements:

- Touchpanel is directly connected to a sceneCOM evo via an Ethernet cable.
- Touchpanel and sceneCOM evo each use their default IP address.

### 3.2 Commissioning version 2: touchpanel connected to sceneCOM evo within a network

1. Connect the voltage supply to the touchpanel.  
Chromium browser starts in kiosk mode.
2. Tap the four corners of the touchpanel, starting at the top left and following a U shape (top left, bottom left, bottom right, top right).  
The device settings are displayed.
3. Switch to the Network settings tab.
4. Enable Static IP address.  
You can also obtain the IP address automatically.  
Activate DHCP instead of static IP address.
5. Set the IP address, subnet mask, default gateway and DNS server of the touchpanel so that it is in the same network as the sceneCOM evo.
6. Tap Apply changes.
7. Switch to the Homepage tab.
8. Enter the IP address of the sceneCOM evo.
9. Tap the X icon at the top left.  
A connection to the sceneCOM evo is established.  
The start page of the sceneCOM web application is displayed.

## 3.3 Safety instructions



The device may only be used for the specified area of application.

Relevant health and safety regulations must be observed.

The voltage supply must be disconnected when the device is being assembled and installed.

Only qualified personnel may assemble, install and commission the device.

### 3.4 Wiring examples

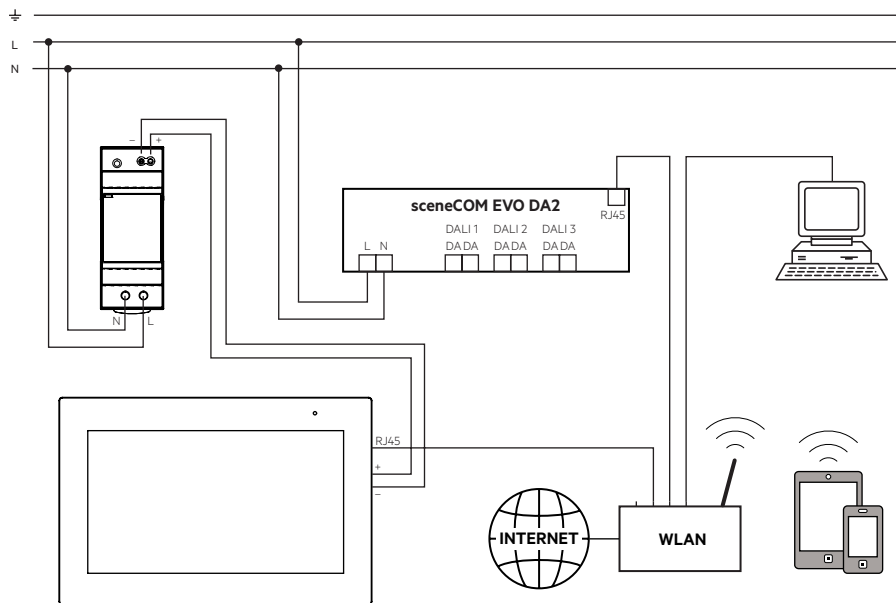

### 3.5 Wiring type and cross section sceneCOM evo DA2 Controller

For wiring use stranded wire with ferrules or solid wire from 0.5 to 1.5 mm<sup>2</sup>.

wire preparation:  
0.5 – 1.5 mm<sup>2</sup>

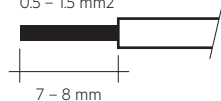

## 4. Supply line

Conductor cross-section	Maximum line length
0.5 mm <sup>2</sup>	15 m
1.0 mm <sup>2</sup>	30 m
1.5 mm <sup>2</sup>	55 m

## 5. Miscellaneous

### 5.1 Disposal of equipment



Return old devices in accordance with the WEEE directive to suitable recycling facilities.

### 5.2 Additional information

Additional technical information at [www.tridonic.com](http://www.tridonic.com) → Technical Data

Lifetime declarations are informative and represent no warranty claim.  
No warranty if device was opened.