

**EM pLED PRO LiFePO4 180lm 3h Kit**

Combined emergency lighting LED driver 1 – 4 W



EM AP Lighthouse 18mm



EM AP Lighthouse 36mm

**Product description**

- \_ The EM AP Lighthouse Kit is a self-contained solution for diverse applications
- \_ 18 mm variant for built-in applications
- \_ 36 mm variant for independent use
- \_ The complete set includes an EM powerLED 1W, the antipanic lighthouse with integrated indication LED, LiFePO4 battery and the fixing flange nut
- \_ EM AP LIGHTHEAD with 180 lumen light output
- \_ IP65 for EM AP Lighthouse in installed state
- \_ SELV for output voltage < 60 V DC
- \_ Non maintained operation
- \_ DALI-2 interface for controlled testing and monitoring
- \_ 3 h rated duration
- \_ EM = Emergency
- \_ Nominal lifetime up to 100,000 h
- \_ 5 years guarantee (conditions at <https://www.tridonic.com/en/int/services/manufacturer-guarantee-conditions>)

**Battery management**

- \_ Intelligent charge system
- \_ Deep discharge protection
- \_ Temperature protection
- \_ Polarity reversal protection for battery provided by 3-pole connector

**Batteries**

- \_ LiFePO4 batteries with Tridonic LiFeGuard
- \_ Temperature-protected
- \_ Overcharge-/Overdischarge protection
- \_ Ensures safety in use
- \_ LiFePO4: up to 12 years design life
- \_ 8 years guarantee for LiFePO4 batteries (conditions at <https://www.tridonic.com/en/int/services/manufacturer-guarantee-conditions>)

**Website**

<http://www.tridonic.com/89801290>



**EM pLED PRO LiFePO4 180lm 3h Kit**

Combined emergency lighting LED driver 1 – 4 W

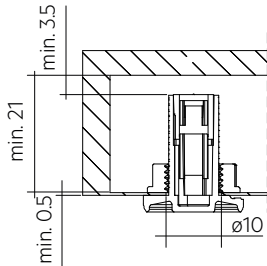

EM AP Lighthouse 18mm

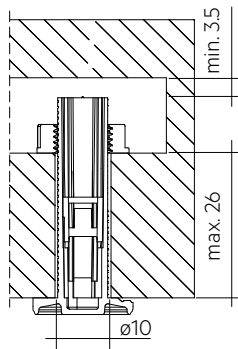

EM AP Lighthouse 36mm

**Ordering data**

Type	Article number	Dimensions L x W x H	Rated duration	Max. number of LEDs	Packaging, carton	Packaging, pallet	Weight per pc.
<b>Screw fastening version</b>							
EM pLED PRO LiFePO4 180lm KIT 18mm	89801290	139 x 30 x 21 mm	3 h	1	5 pc(s).	360 pc(s).	0.233 kg
EM pLED PRO LiFePO4 180lm KIT 36mm	89801292	139 x 30 x 21 mm	3 h	1	5 pc(s).	360 pc(s).	0.233 kg

**Technical data**

Rated supply voltage	220 – 240 V
AC voltage range	198 – 264 V
Mains frequency	50 / 60 Hz
Overvoltage protection	320 V (for 48 h)
THD (at 230 V, 50 Hz, full load)	< 120 %
U-OUT (including open- / short-circuit and double load)	15 V
Max. open circuit voltage	15 V
Output current tolerance	± 10 %
Typical output LF current ripple at full load	± 5 %
Starting time (at 230 V, 50 Hz, full load)	< 0.5 s
Output current	350 mA
Ambient temperature ta <sup>①</sup>	-25 ... +55 °C
Max. casing temperature tc	75 °C
Mains voltage changeover threshold	According to EN 60598-2-22
Mains surge capability (between L - N)	1 kV
Surge voltage at output side (against PE)	< 1.5 kV
Mains surge capability (between L/N - PE)	2 kV
Risk group (IEC 62471)	RG2 (Eth <sub>r</sub> = 658 lx, RG1 > 51 cm)
Type of protection	IP20
Lifetime	up to 100,000 h
Guarantee (conditions at www.tridonic.com)	5 Year(s)

**Approval marks****Standards**

EN 61347-2-7, EN 61347-2-13, EN 62384, EN 55015, EN 61000-3-2, EN 61000-3-3, EN 61000-4-11, EN 61547, EN 60068-2-29, EN 60068-2-30, EN 60068-2-64, EN 62031, EN 62386 (acc. to DALI standard V2), according to EN 50172, according to EN 60598-2-22, acc. to EN 62034

<sup>①</sup> Ambient temperature ta EM AP Lighthouse: -25 ... + 45 °C.